Data sheet

Article Description

Article Picture

Push-button Switch Type 3030

2(1) A, 250 V~, on-off/switch, 1-pole, T 85° C,
screwed on bell-shaped nut

- for cables H03VV-F 2 x 0,75 mm²,
H03VV-F 3G 0,75 mm², H03VVH2-F 2 x 0,75 mm²
- central fitting M 10 x 1 mm
- screw terminals (suitability for terminals for
connecting unprepared conductors)
- degree of pollution : 2
- switching cycles: 1E4 (10.000)
- switching characteristics: complete shutdown
- Comparative of Creepage-
proof tracking index (PTI): 175 V
- rated value of impulse
withstand voltage : 2,5 kV U (imp)



constant switch position

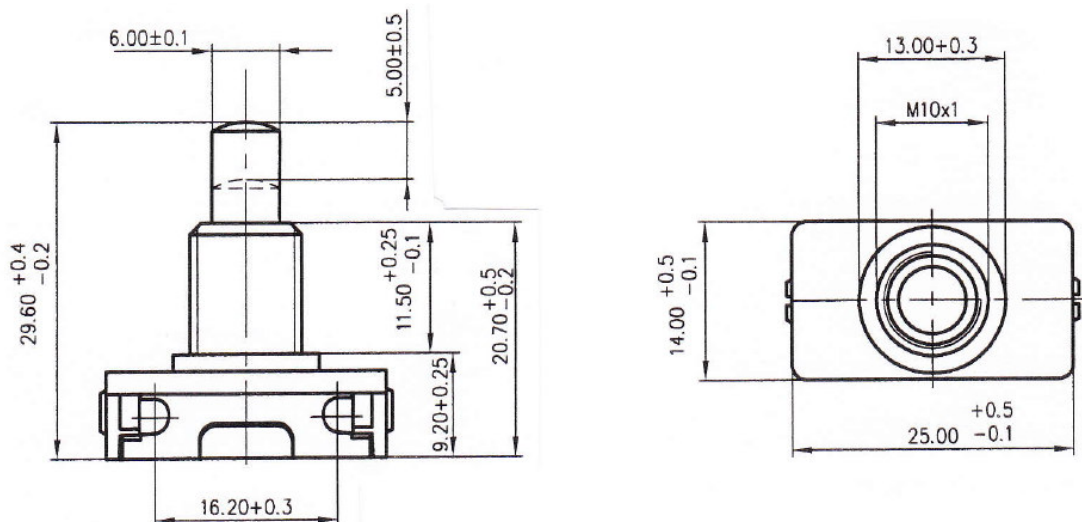

<i>inter BÄR-No.</i>	<i>Colour button</i>	<i>thread lenght</i>
3030-276...	white	11,5 mm
3030-277...	black	11,5 mm

Technical modifications reserved!
Works at 230 V-mains must only be carried out by a specialist!